



New Road
Neath Abbey, Neath, SA10 7NG

Offers in the region of £250,000



New Road

Neath Abbey, Neath, SA10 7NG

Located on New Road in the popular area of Neath Abbey, and with no onward chain, this well-proportioned end terrace property with parking to the rear of the property, offers a delightful blend of comfort and convenience. With three spacious bedrooms and a purpose built office located in the loft, this property is perfect for families or those seeking extra room for guests or a home office. The outbuilding offers a perfect opportunity for a home office or workshop with electric.

The house features one bathroom and a ground floor shower room with a dedicated utility area, adding to the practicality of the home, providing additional storage and laundry space.

Set back from the main road, this property offers a private setting with being easily accessible to local amenities and transport links. The rear parking is a significant advantage, offering convenience and security for your vehicle.

This end terrace house on New Road is an excellent opportunity for those looking to settle in a friendly community with a comfortable living space. Don't miss the chance to make this lovely property your new home.

EPC - TBC





Floor Plan

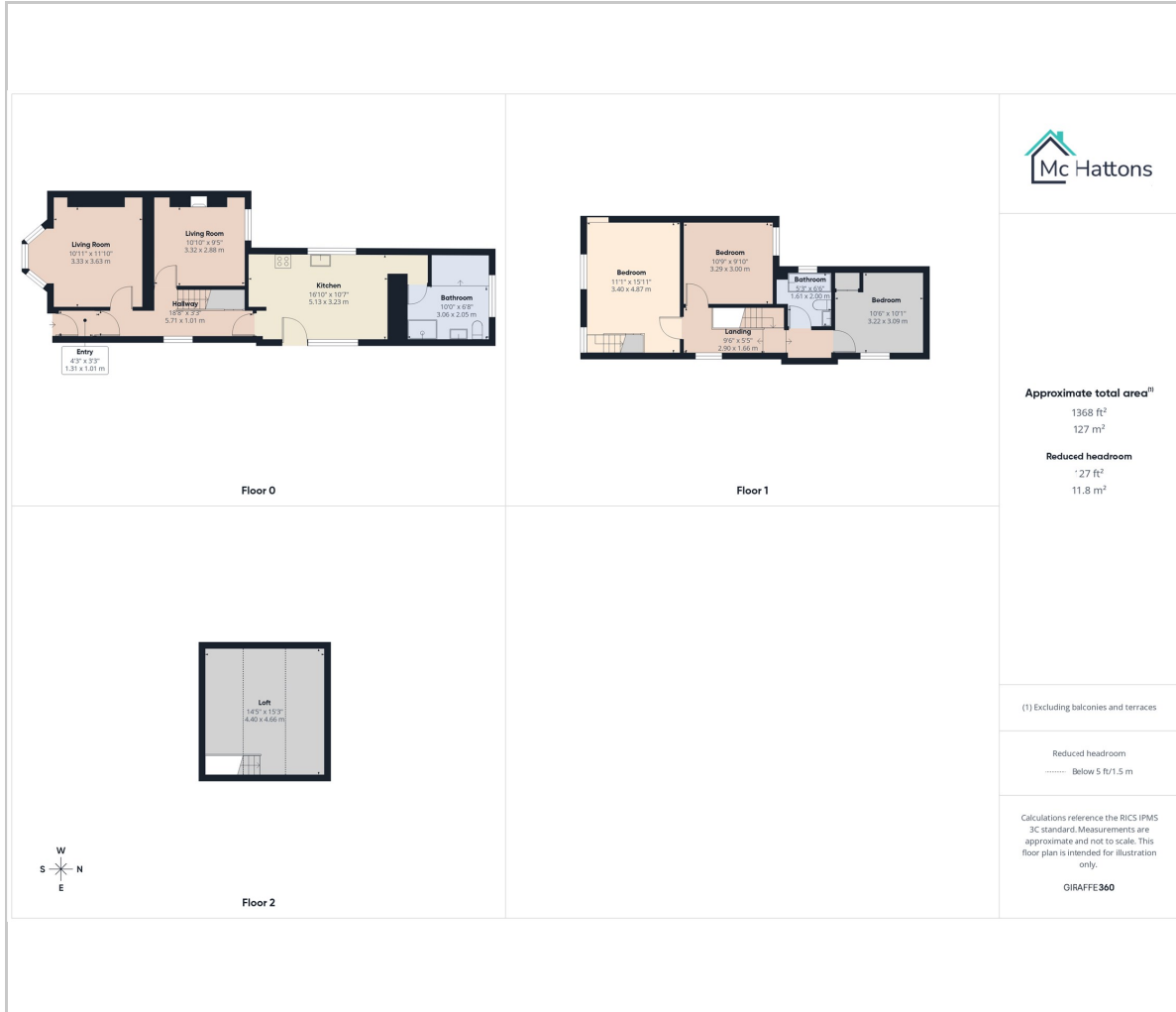

Area Map



Energy Efficiency Graph

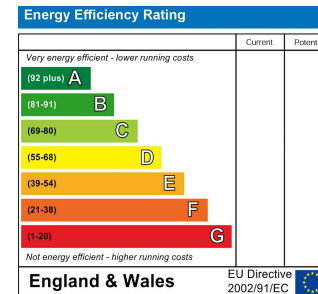

Viewing

Please contact our McHattons - Neath Office on 01639 501766 if you wish to arrange a viewing appointment for this property or require further information.

These particulars, whilst believed to be accurate are set out as a general outline only for guidance and do not constitute any part of an offer or contract. Intending purchasers should not rely on them as statements of representation of fact, but must satisfy themselves by inspection or otherwise as to their accuracy. No person in this firm's employment has the authority to make or give any representation or warranty in respect of the property.

40 Alfred Street, Neath, SA11 1EH
Tel: 01639 501766 Email: neath@mchattons.co.uk